

Cameron Harris - Properties

Glenfield Industrial Estate, Cowdenbeath

The development at Glenfield Industrial Estate, provides an ideal location for any company wishing to either own or lease a modern flexible industrial unit with good transport links close by. Layouts can be altered to suit any specific requirement.

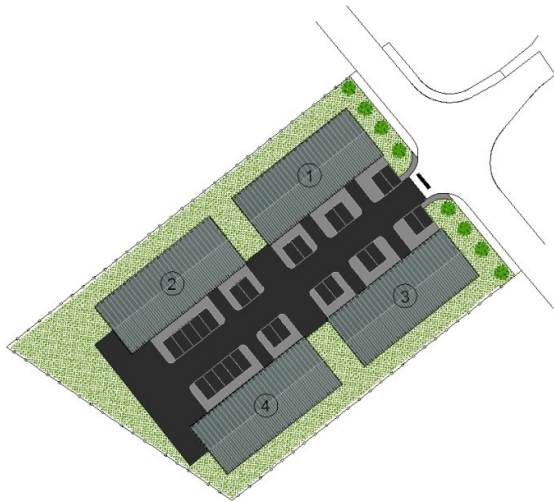

Unit 1 – 3,900 sqft industrial starter unit – **available for sale or let** can be subdivided

Unit 2 – two 1,900 sqft industrial starter units – **available for sale or let**

Unit 3 – 3,900 sqft industrial starter unit – **available for sale or let** can be subdivided

Unit 4 – two 1,900 sqft industrial starter units – **available for sale or let**

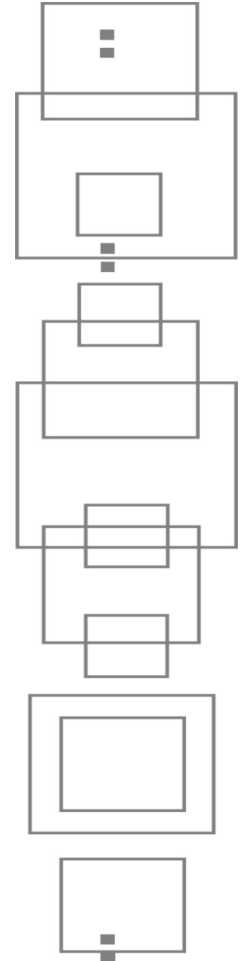

CameronHarris
design ■ ■ build

For further information call 01383 621 890